



*Leabharlann
Náisiúnta
na hÉireann*

National Library
of Ireland

Visual Guide

National Library of Ireland



1. Introduction

The National Library of Ireland(NLI) is a place for research, study, learning and history. This guide will help you prepare for your visit and know what to expect.

2. The range of services on offer in the NLI include:

- **Entrance Hall:** The reception desk and the Lego Model of the Library Building
- **Readers Registration Office:** Is located to the left of the entrance hall
- **Joly Lecture Theatre (Events):** is located on the ground floor to the right of entrance hall.
- **Yeats Exhibition:** The Life of W.B.Yeats, is to the right of entrance hall and is accessible to the lower level via the stairs or the lift
- **Family History Service:** Explore your family history (this service is accessed via the main stairs behind reception desk and a Reader's Ticket is required)
- **Reading Room:** Is a quiet space where people study using Wi-Fi, and by reading library books (requested in advance). It is located on the first floor, accessible by the main stairs, or staff-accompanied by lift (Reader's Ticket required)
- **Public Toilets:** Down the stairs past reception, with accessible toilets available on the ground floor
- **Manuscript Reading Room:** Where people study unique documents (not books), it is located in a different building at 2/3 Kildare Street. There are steps at the entrance and wheelchair access is available

3. Before You Arrive

- Check opening hours on our website - www.nli.ie/visit/opening-hours
- If you want to use the reading rooms, you need a Reader's Ticket
- You can apply online at www.nli.ie or in person
- Bring photo ID (passport, driver's licence, or student card) to collect your ticket

4. Arriving at the Library

The main entrance is on Kildare Street, in the centre of Dublin.

That means it can sometimes be very busy with transport and people.



- The double doors straight ahead on arrival are operated by a push button, or use the standard door to the left
- Staff at the reception desk can provide directions
- If you need help with accessibility, staff are happy to assist
- The Reader's Registration office is located to the left of reception. You may have to queue for a ticket



5. Meeting Library Staff

- Library staff wear badges or lanyards to help you recognise them
- They can help answer questions about the library and its collections
- If you need assistance, feel free to ask them



6. Navigating the Library

- The Front Hall has a digital screen with information about exhibitions and events
- The Main Reading Room is up the main staircase.
- The Yeats Exhibition and Joly Lecture Theatre are fully accessible
- If you are using the reading rooms or family history, you must place your bag, food and drinks in a locker behind reception
- The Family History Room is on the mezzanine level - up the main staircase and to the right. This is where members of the public go to find out about their family history



7. Sensory Considerations

- The library's Front Hall can be busy, noisy and echoey or quiet, depending on the time of day
- If you need a quiet space, ask staff for guidance
- Some areas have low lighting due to conservation policies.
- Public toilets can be echoey
- If required sensory toys are available at reception



8. Accessibility Features

- Ramps are available externally
- Lifts are available internally
- Accessible toilets are to the right of reception and near and Joly Lecture Theatre
- Public toilets are past reception and down the stairs
- Staff can provide directions or assistance at any time



9. Leaving the Library

- You can exit through the main doors
- If you need help, ask a staff member
- Visit www.nli.ie for more details or contact info@nli.ie



Map of Main Building

Located at 7/8 Kildare St, Dublin, Do2 P638

Ground Floor - Entrance

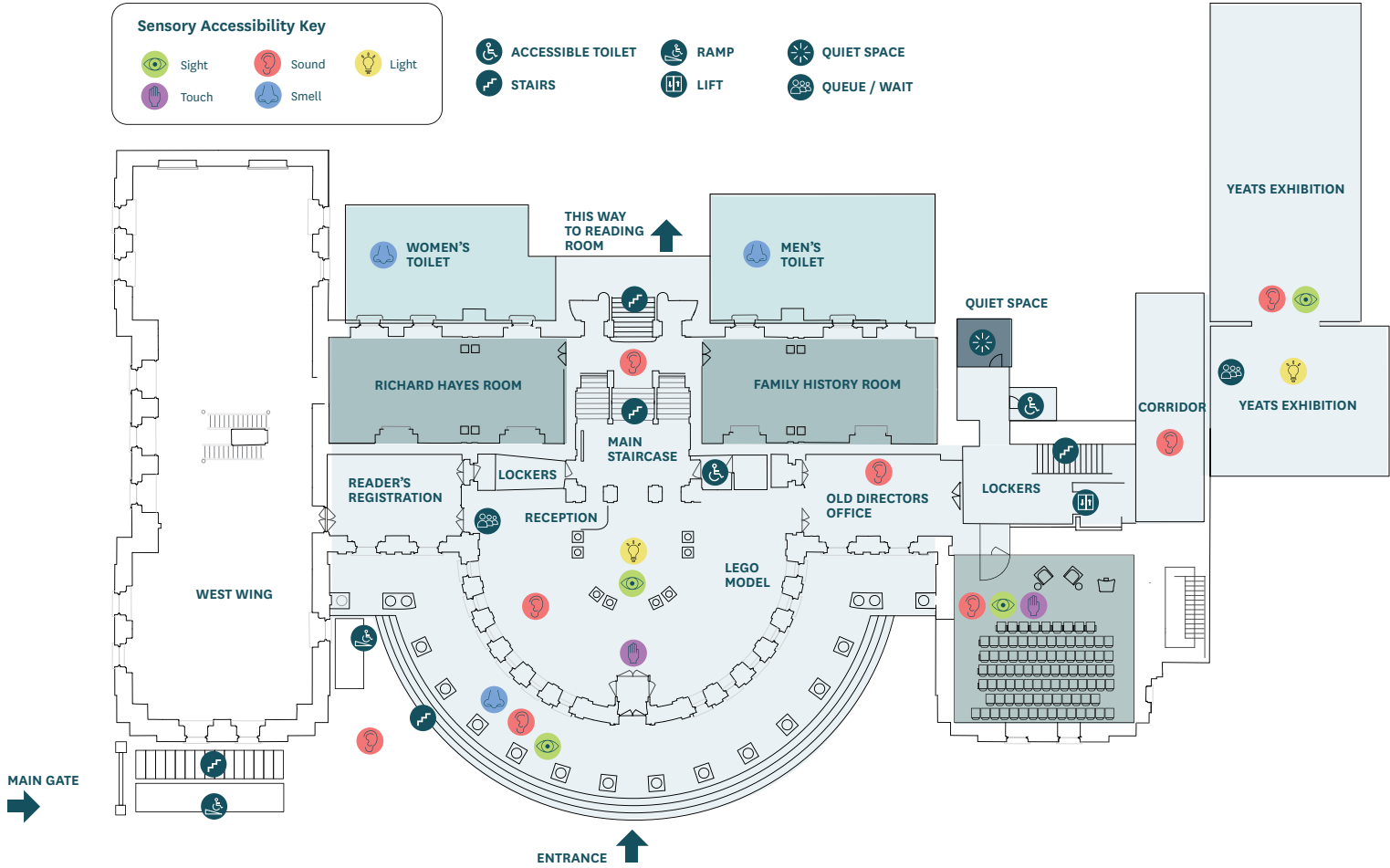

1st Floor - Reading Room

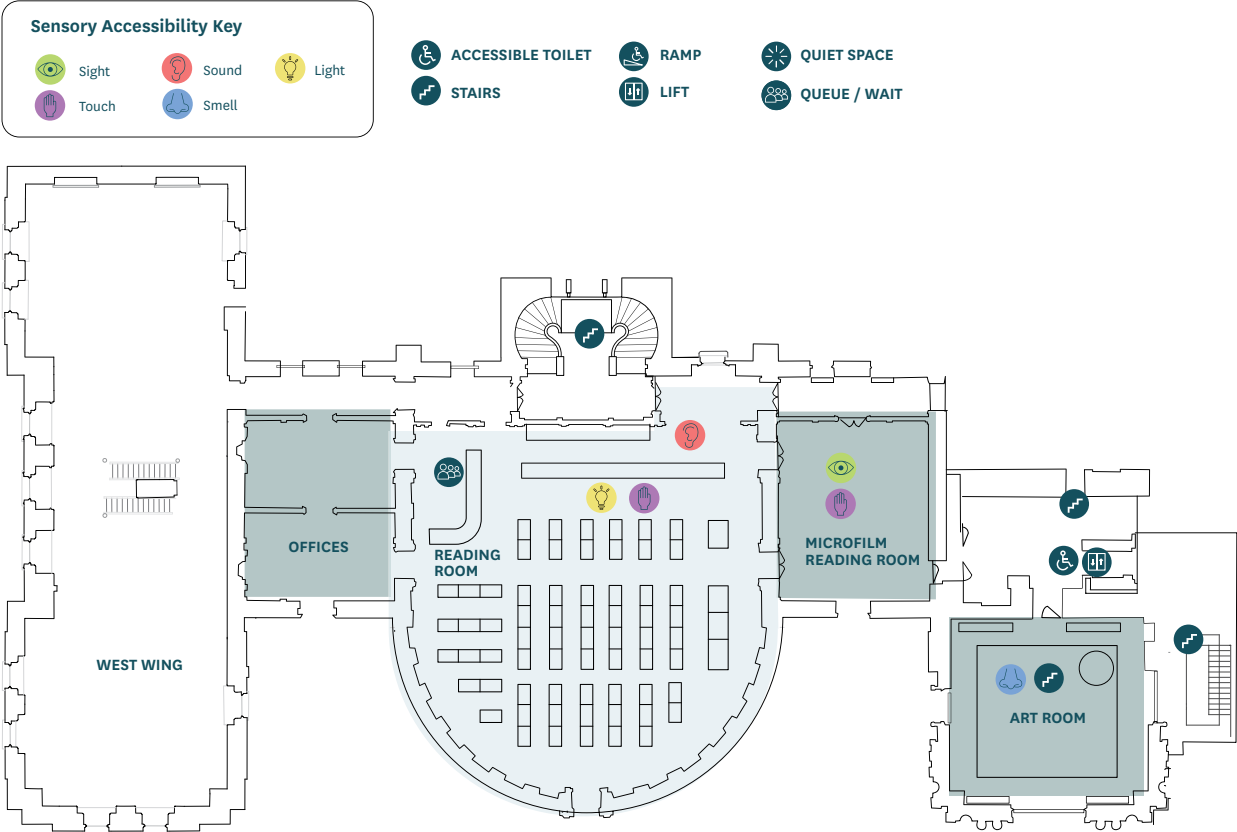



Manuscripts Reading Room

Located at 2/3 Kildare St, Dublin, D02 TR76

Sensory Accessibility Key

 Sight

 Sound

 Light

 Touch

 Smell

 ACCESSIBLE TOILET

 RAMP

 QUIET SPACE

 STAIRS

 LIFT

 QUEUE / WAIT

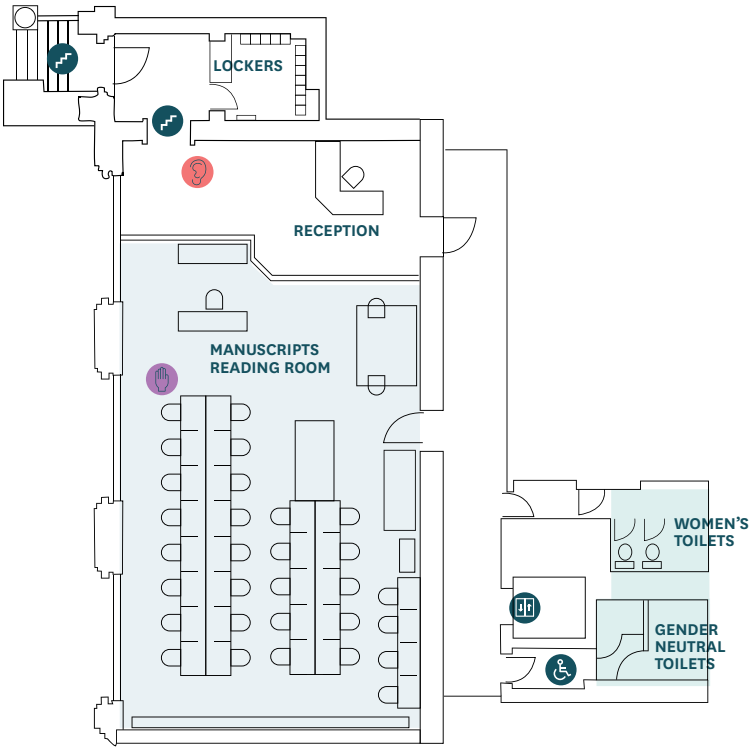



*Leabharlann
Náisiúnta
na hÉireann*

National Library
of Ireland

Any queries about accessing our buildings or services for persons with disabilities please contact NLI Access Officer by email access@nli.ie or telephone +353 (0)1 6030265.

www.nli.ie/visit/accessibility